

LEGEND

●	(FH) FIRE HYDRANT
⊗	(VS) STOP VALVE
⊗	(VA) SCOUR ASSEMBLY
□	(TB) TAPPING BAND
⊗	(WM) WATER METER (SEQ 20φ)
┌	END CAP
└	TEE
^	REDUCER
○	BEND
—	DICL WATER MAIN CROSSING
----	CONDUIT/CROSSING
—	EXISTING WATER

NOTES

- ALL FIRE HYDRANTS ARE #100 SPRING U.N.O.
- ALL WATER SERVICE PIPE CONDUITS ARE #100 PVC PN12 U.N.O.
- ALL WATER MAINS PIPES ARE PN16 U.N.O.

REGISTERED SURVEYOR'S CERTIFICATION

LandPartners Pty Ltd hereby certify that the vertical and horizontal locations and dimensions shown on this plan are a true and correct record and were located by survey.

R. G. Andrew
LandPartners Pty Ltd, Reg. Surveyor No. S4118 Date: 16/03/2023

ENGINEER'S CERTIFICATION

I, _____, hereby certify that:

- The information contained in this drawing / document is in compliance with approved drawings and design.
- The new water and sewerage works defined by this drawing have been designed and constructed in accordance with the SEQ Code.
- This represents an accurate record of as-constructed works.
- I accept responsibility for the information contained in this drawing / document.

RPEQ (signature) RPEQ No. _____ Date: _____

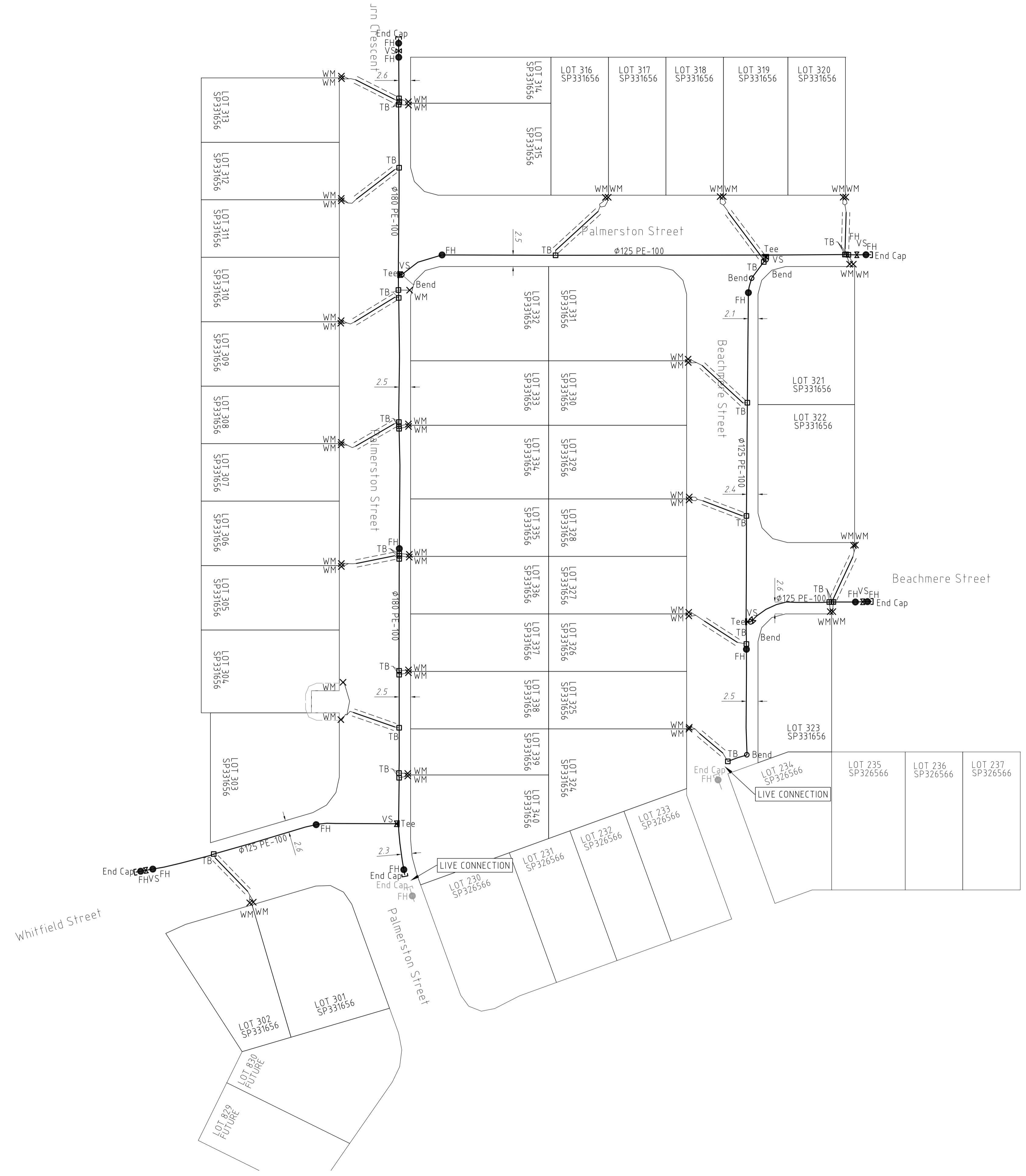

AS CONSTRUCTED

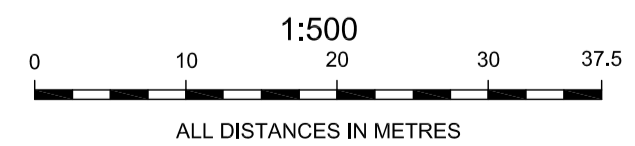

A1	1	15/03/2023	INITIAL ISSUE	B.B	RA	RA
	INDEX	DATE	REVISIONS	DRAWN	CHECKED	PASSED

DRAWN	B.B	15/03/2023
CHECKED	RA	16/03/2023
PASSED	RA	16/03/2023
INITIALS	DATE	



Queensland Urban Utilities

AURORA STAGE 3
AS CONSTRUCTED WATER
21-PNT-54735

SCALE 1:500
SHEET 1 OF 1 SHEETS
DRAWING NO.
BRSS5365-003-71-1